

WL2FLT TOWER LAYOUT DRAWING AND PARTS LIST

Yellow = Consumables

Green = Recommended spare parts

Wetted Parts

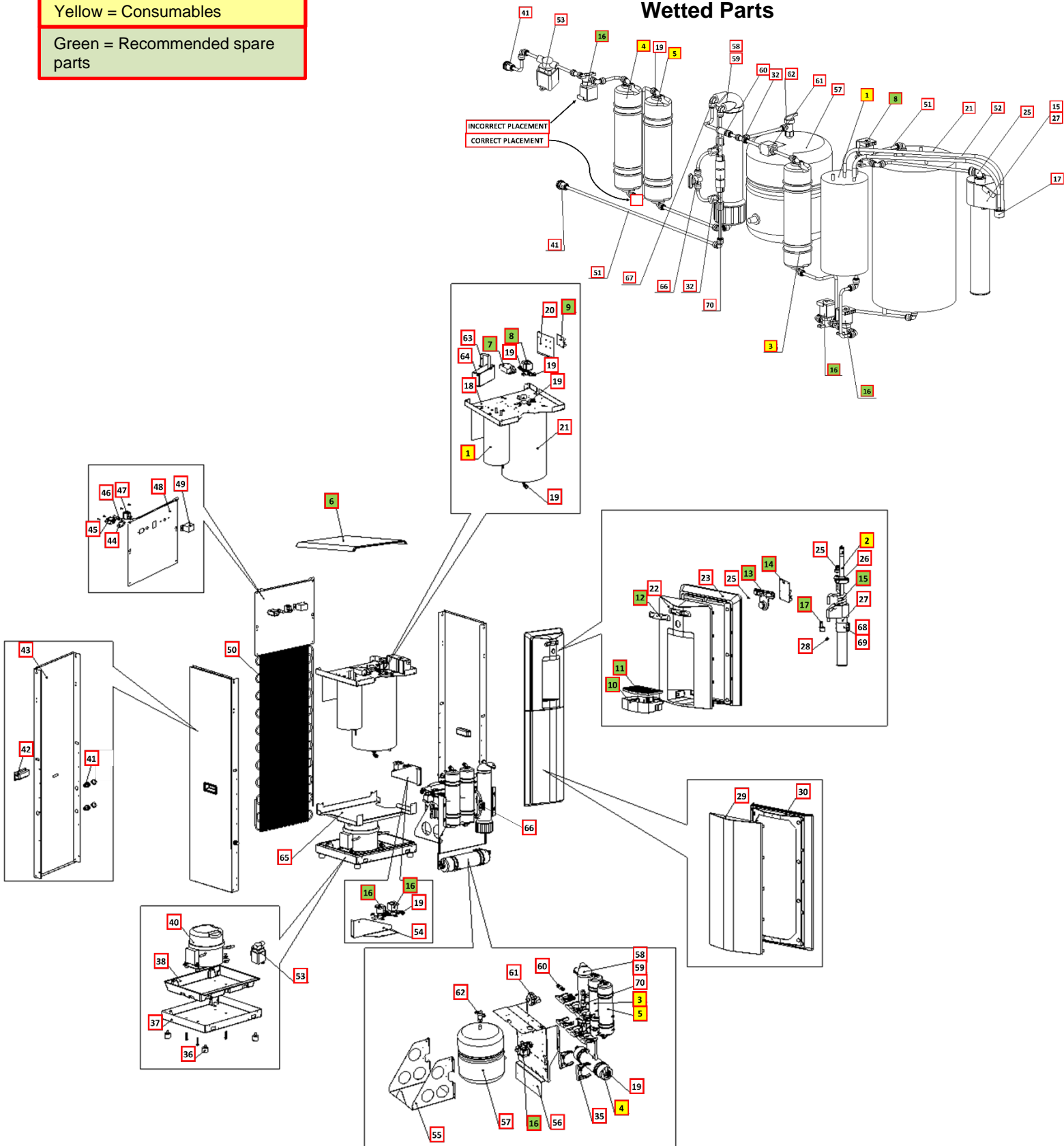

WL2FLT TOWER LAYOUT DRAWING AND PARTS LIST





No	WLUSA Part Number	Description	Factory Part Number	Stocked?	
Consumables					
1	10-4029	Hot Tank 120V/500W - 1.6L with Thermistor	HT-3024	Yes	
2	12-8310	15W X UV Lamp Assembly	CT-2085-LA0-00	Yes	
3	FT-0035	GAC Filter - 10" Carbon Activated Inline Filter	FT-0035-IL-WLT	Yes	
4	FT-0053	Sediment Filter - 10" Sediment 20 Micron Inline Filter	FT-0053-IL-WLT	Yes	
5	FT-0014	1-micron 10" Inline CBC Filter for CTO, Lead, Cyst and Asbestos Reduction – Carbon Block	FT-0014-IL-WLT	Yes	
Not shown	01-2076	Scale Kleen	NA	Yes	
Recommended Spare Parts					
1.1	12-1360	Overload with Manual reset - 221°F (105°C) <i>Recommend stocking 2 each per 10 units purchased</i>	HT-3012	Yes	
1.2	12-6900	Overload Metal Cover <i>Recommend stocking 2 each per 10 units purchased</i>	ST-8290	Yes	
6	PL-0191-L00-BL	Black Top Cover <i>Recommend stocking 2 each per 10 units purchased</i>	PL-0191-L00-BL	Yes	
7	EN-0008-LA1-00	13W / 15W 120V / 60Hz Electronic FX Ballast <i>Recommend stocking 2 each per 10 units purchased</i>	EN-0008-LA1-00	Yes	
8	PU-4017	Solenoid Valve DC24V 500mm <i>Recommend stocking 2 each per 10 units purchased</i>	PU-4017-B	Yes	
9	EN-6134	FW2 Extra hot Main PCB <i>Recommend stocking 2 each per 10 units purchased</i>	EN-6134	Yes	
9.1	10-3017	Plastic PCB Support <i>Recommend stocking 2 each per 10 units purchased</i>	EN-6059	Yes	
10	PL-0194-L00-BL	Black Drip Tray Body <i>Recommend stocking 4 each per 10 units purchased</i>	PL-0194-L00-BL	Yes	
11	PL-0195-L00-BL	Black Drip Tray Grill <i>Recommend stocking 4 each per 10 units purchased</i>	PL-0195-L00-BL	Yes	

12	LP-0422-L00-00	Hot and Cold User Interface Label <i>Recommend stocking 2 each per 10 units purchased</i>	LP-0422-L00-00	Yes	
13	PL-0199-L00-00	Hot and Cold Dispense Silicon Button Mat <i>Recommend stocking 2 each per 10 units purchased</i>	PL-0199-L00-00	Yes	
14	EN-0147-L00-00	WL2FWFL Display PCB H&C w/ Pedal – Ver. 2 <i>Recommend stocking 2 each per 10 units purchased</i>	EN-0147-L00-00	Yes	
15	12-8305	Quartz Spiral UV Faucet <i>Recommend stocking 2 each per 10 units purchased</i>	FU-0007	Yes	
16	PU-0017-L00-00	Solenoid Valve MS DC SWV24-01 <i>Recommend stocking 2 each per 10 units purchased</i>	PU-0017-L00-00	Yes	
17	12-8370	Hot Water Faucet <i>Recommend stocking 2 each per 10 units purchased</i>	PL-1351	Yes	
Remainder of Parts					
18	12-8003	Upper Shelf	ST-8136-R2	Yes	
19	Purchase from John Guest	JG Equal Elbow Connector 1/4" John Guest P/N PI0308S	PU-4008	No	
20	12-5245	Main PCB Bracket	ST-8165-CN	Yes	
21	CT-2017-A	Cold Tank Assembly - 4Liters	CT-2017-A	No	
22	PL-0202-L00-BL	Black Front Top Panel	PL-0202-L00-BL	Yes	
23	PL-0192-L00-SI	Silver Front Top Panel Trim	PL-0192-L00-SI	Yes	
24	EL-0148-L00-00	LED Light Pipe	EL-0148-L00-00	Yes	
25	Purchase from John Guest	JG 3/8" x 1/4" Reducing Elbow (PI211208S)	PU-4137	No	

26	12-8320	Firewall UV Lamp Rubber	CT-2088	Yes	
27	FW-0027	Firewall Mark IV Stainless Assy No internal components	FW-0027-L00-00	Yes	
28	AK-0064	UVC Sensor Assembly	AK-0064	Yes	
29	PL-0301-L00-00	WL2FLT Front Down Panel	PL-0301-L00-00	Yes	
30	PL-0302-LA0-00	WL2FLT Front Down Trim	PL-0302-LA0-00	Yes	
31	Purchase from John Guest	JG Reducing Elbow Connector 5/16" * 1/4" (PI211008S)	PU-4007	No	
32	Purchase from John Guest	JG Equal Tee Connector 1/4" (PI0208S)	PU-4011	No	
33	CU-0001	Solenoid Cushion	CU-0001	Yes	
34	12-8005	Filter Bracket	ST-8138	Yes	
35	20-1010	2.8" Filter Clip	PU-4161	Yes	
36	ST-8167CN	Unit Rubber Feet	ST-8167CN	Yes	
37	12-8004	Bottom Tray	ST-8137	Yes	
38	12-3155	Leak Tray	PL-1294-A	Yes	
39	12-3180	Leak Containment Tray Clip (sensor 0.5mm)	ST-8207-CN	Yes	

Verify compressor in machine before ordering parts as the Compressor P/N CO-0020-L00-00 and 10-2200 (CO-0001A) and related parts are not interchangeable.

CO-0020-L00-00 Compressor (China model)

40A.1	CO-0020-L00-00	LG Compressor 120V R134A CSB035LJCM	CO-0020-L00-00	Yes	
40A.2	CO-0019-L00-00	Compressor Capacitor	CO-0019-L00-00	Yes	
40A.3	ST-0216-L00-00	Capacitor Bracket	ST-0216-L00-00	Yes	
40A.4	CO-0017-L00-00	PTC Relay	CO-0017-L00-00	Yes	
40A.5	CO-0018-L00-00	Overload Protector	CO-0018-L00-00	Yes	

CO-xxxx-L00-00 Compressor (USA model)

40B.1	CO-0043-I00-00	LG Compressor 120V R134A CSB035LJCM	CO-0043-I00-00	Yes	
40B.2	ST-0216-L00-00	Capacitor Bracket	ST-0216-L00-00	Yes	
40B.3	CO-SS01-L00-00	PTC Relay	CO-SS01-L00-00	Yes	
40B.4	CO-SS02-L00-00	Overload Protector	CO-SS02-L00-00	Yes	
40.1	12-1001	Filter Dryer	CO-9008	Yes	
41	10-3067	Bulkhead Union 1/4" x 1/4" John Guest P/N PI1208S	PU-4028	Yes	
42	10-4004	Black Plastic Handle	PL-1120	Yes	
43	ST-0338-L00-00	Tower Side Panel (Tall) - Black	ST-0338-L00-00	Yes	
44	19-1015	Gasket for Power Socket	ST-8052	Yes	
45	19-1090	Power Line Noise Filter, ElectroMagnetic Interference filter (EMI)	EL-5029	Yes	
46	10-3014	Fuse Holder and Fuse 120V / 15A with One Wire	EL-5053	Yes	

46.1	10-3013	Fuse 120V / 15A	EL-5010	Yes	
47	12-5600	Red Heater and Compressor Switch	EL-5019-A	Yes	
48	ST-0339-L00-00	Tower Back Panel (Tall) - Black	ST-0339-L00-00	No	
49	19-1069	Cold Tank Thermostat 3°C (37.4°F)	CT-2070-A	Yes	
49.1	LP-0326	Cold Thermostat Cover Label	LP-0326-L00-00	Yes	
50	12-8102	Wire Condenser	CO-9027	No	
51	Purchase from John Guest	JG LLD PE Tube - Blue O.D.1/4" John Guest P/N PE-08-BI-1000F-B	PU-4031	No	
52	10-7040	Silicon Tube 5/16" for hot water	PL-4064-L00-00	Yes	
53	PU-0061-L00-00	Stormtech Mechanical Leak Detector	PU-0061-L00-00	Yes	
54	ST-0006-L00-WH	FW2 RO Solenoid Valve Fixing Bracket	ST-0006-L00-WH	Yes	
55	ST-0004-L00-WH	FW2 RO Bladder Tank Fixing Bracket	ST-0004-L00-WH	Yes	
56	ST-0003-L00-WH	FW2 RO Filter Bracket	ST-0003-L00-WH	Yes	
57	CT-0001-L00-00	RO Pressurized Tank (2 Gallons) – FW2 RO	CT-0001-L00-00	Yes	
58	RO-0003-A	RO Housing Micro	RO-0003-A	Yes	
59	RO-0099	RO Membrane FilmTec BW60-1812-75	RO-0099	Yes	
60	PU-4057	JG Non-Return Valve 1/4"	PU-4057	Yes	
61	RO-0024	High Water Pressure Switch	RO-0024	Yes	
62	PU-4082	JG Shut Off Valve NPT 1/4" (PPSV500822W)	PU-4082	Yes	
63	ST-8315	WL400 Adapter Bracket	ST-8315	Yes	

64	RF-0001-L00	Power Adaptor (24V) for Pump for FW2 RO	RF-0001-L00	Yes	
65	ST-0007-L00-WH	WL2000 + 2500 FS upper front Shelf (universal to ST-8136)-FW	ST-0007-L00-WH	Yes	
66	RO-0010-A	Flushing Valve Micro	RO-0010-A	Yes	
67	RO-0006-A	¼" Rigid Elbow for RO Housing Micro	RO-0006-A	Yes	
68	FU-0010	UVC Sensor Fixing Metal Bracket (w/Tube)	FU-0010	Yes	
69	FU-0011	UVC Sensor Fixing Metal Bracket Back	FU-0011	Yes	
70	RF-0004-L00-00	RO Flow Restrictor w/ Quick Fitting	RF-0004-L00-00	Yes	
Not Shown	10-3007	Power Cord 120V – 18240mm	EL-5001-B	Yes	