

WL2FLT

RO to Filtration Conversion Guide



Waterlogic Commercial Products, LLC
3175 Bass Pro Drive
Grapevine, TX 76051
(800) 288-1891 www.waterlogicdealers.com
Tech Portal Website: wld-portal.waterlogic.com

CONVERSION FROM RO TO FILTRATION CONFIGURATION

The **WL2FLT** comes standard with 4-stage RO filtration system installed inside the lower cabinet. If the user prefers carbon filtration only, the unit can be converted to a filter only system (by removing the RO components). The process for converting the unit to a filter only system is detailed below.

This process should be done before running water through the machine, otherwise the unit will need to be completely drained before continuing. Please refer to the WL2FLT manual for draining procedures.

Disconnect the machine from water source and shut OFF Red Heater/Compressor switch before starting.



1. Remove the lower front panel by removing the two screws at the bottom of the panel.

2. Disconnect the line running from the inlet bulkhead to the leak-stop **AT** the leak-stop. Disconnect the drain line from the RO flush assembly at the elbow close to the Leak Stop Mechanism.

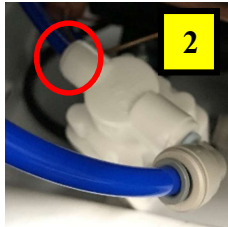

3. Disconnect the line running from the outlet of the GAC filter to the tee between the hot and cold solenoids **AT** the tee.

4. Disconnect the Pressure Switch wire from both connectors at the branch in the wires. One branch runs up to the PCB, and the other to the Inlet Solenoid. Some newer models may have spade connections that attach to the Inlet solenoid. In this case, disconnect the spade connections from the Inlet solenoid.

5. Remove the 4 screws at the front of the RO bracket holding it to the unit. The entire RO assembly can now be removed from the unit.

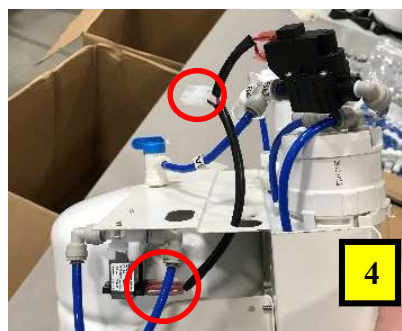
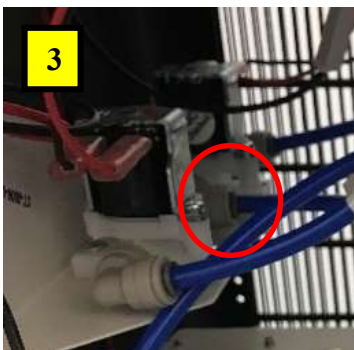

6. Shut off the Bladder Tank Valve. Disconnect line from the Membrane Inlet and disconnect line from the Bladder Tank Valve. Disconnect line running to the elbow of the Pressure Switch AT the elbow.

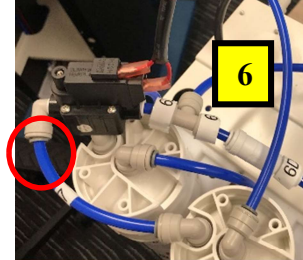
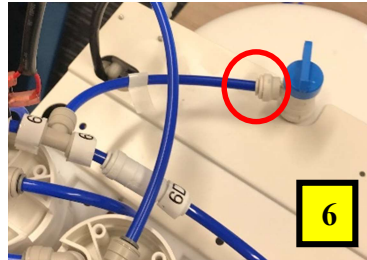
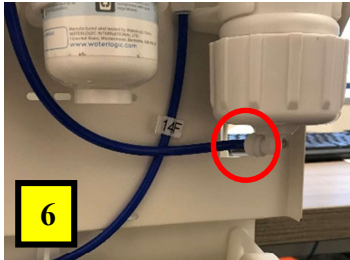

7. Remove Membrane from clips with all tube assemblies and Pressure Switch still attached and set aside.

8. Remove the screws of the metal tank strap on the back of the assembly holding the Bladder Tank in place. Remove the Bladder Tank and set aside.

9. Disconnect lines from both ends of the Inlet Solenoid, then remove the solenoid by removing the screws holding it in place and set aside.

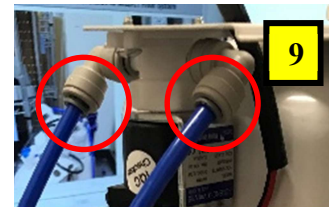

10. Pull Carbon Block Filter from the clips, remove any tubing from the elbows, and move to location of the membrane (furthest to the right).

11. Move the Sediment Filter to the first filter slot in the bracket. Using existing tubing, or cutting new sections if available, plumb the three filters in series into the water circuit. Water should flow through the Leak Stop, to the Sediment Filter (FT-0053), then to the GAC Filter (FT-0035), then to the CBC Filter (FT-0014). Connect a section of tubing about 10-12" long to the outlet of the CBC Filter, it will be used later.

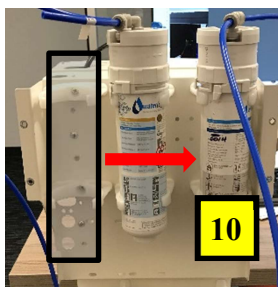

NOTE: The CBC Filter (FT-0014) included with the WL2FLT is rated for 10microns. It is recommended to swap this filter out with CBC Filter (FT-0063) with the removal of the RO system.

12. Remove the tubing still connected to the drain port inside the machine.



Drain port is located beneath shelf shown in photo.

13. Place the filter assembly back onto the shelf inside of the machine and secure with the 4 screws. Reconnect the tube from the inlet bulkhead to the Leak Stop. Secure the Leak Stop to the bottom of the leak tray, with the bottom flat against the tray.

14. Connect the outlet tube of the CBC filter to the Tee between the Hot and Cold Solenoids.

15. The machine is now in the Filtration configuration, and will no longer create RO water. The machine body panels can now be placed back on the machine and installation can proceed.

