

MODEL/PART DESIGNATIONS

BRAND NAME	DESCRIPTION	MODEL – PART NUMBER
<i>WL400</i> Counter Top	<i>Waterlogic WL400 Counter Top - Ambient, Cold, Hot and Extra Hot</i>	10-WL4FW-SB
	F-4FW-M-HCA-HC2P-SB-INN	
	Serial Number Prefix: 96	
<i>WL400</i> Base Cabinet	<i>Waterlogic WL400 Base Cabinet with RO</i>	10-WL4BC
	F-4FW-M-HCA-HC2P-SB-INN	

SPECIFICATIONS

<u>ITEM</u>	
Water Connection	¼" Quick Connect
Cold Water Temperature	Cold Water Temperature – Factory Set Point 5°C (41°F) Adjustable from 3° - 12.2°C (37° - 54° F.)
Cold Tank Capacity	4 Liters (1 Gallon)
Hot Water Temperature	Hot Water Temperature – Factory Set Point 85°C (185°F) Adjustable from 70° - 95°C (158°F - 203°F)
Extra Water Temperature	Extra Hot Water Temperature – Factory Set Point 95°C (203° F)
Hot Tank Capacity	1.2 Liters (0.3 Gallons)
Hot Water Manual Reset Overloads	97°C (207° F)
Recommended Service Pressure	40-60 psi (275-414 kPa) – Use Pressure Regulator
Maximum Service Pressure	100 psi (689 kPa) – Use Pressure Regulator
Rated Service Flow	378.5 Liters per Day (Lpd) / 100 Gallons per Day (Gpd)
Environmental Temperature	1.67° - 38°C (35° - 100°F)
UV Lamp	13 Watts
Heater	500 Watts
Refrigerant Gas	R134a, 75g, 2.65 ounces
R134a Pressures	High (230 psi), Low (90 psi)

SHIPPING SPECIFICATIONS

<u>ITEM</u>	<u>WL400 Counter Top</u>	<u>WL400 Base</u>	<u>WL400 Tower Combined</u>
Width/Depth/Height	42cm x 44.5cm x 44.5cm (16.5" x 17.5" x 17.5")	42 cm x 44.5cm x 80cm (16.5" x 17.5" x 31.5")	42 cm x 44.5cm x 125cm (16.5" x 17.5" x 49")
Weight (dry) of Box	26 kg (57 pounds)	28 kg (61 pounds)	53.5 kg (118 pounds)
Ship per Pallet	Up to 8 per pallet		4 per pallet in 2 boxes

*WL400 Counter Top is 17.75 in. tall and may not fit between countertops and cabinets - Check installation to ensure adequate clearance.

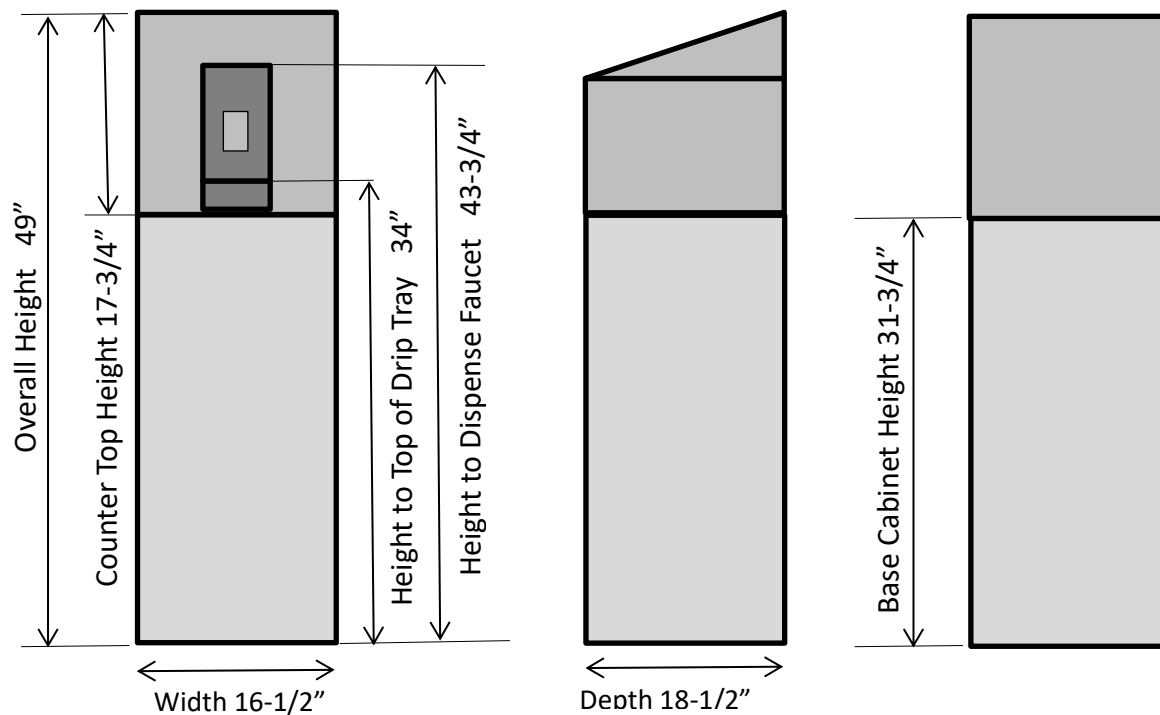

ELECTRICAL SPECIFICATIONS

<u>ELECTRICAL SUPPLY</u>	<u>120V/60Hz</u>	<u>15 Amp Service⁺</u>
<u>COMPONENT</u>	<u>POWER (approximate)</u>	<u>AMP DRAW (approximate)</u>
Heater	500	4.2 Amps
Compressor	114	1 Amp
Fan	16	0.1 Amps
Controls	15	0.1 Amps
UV Lamp System	13	0.1 Amps
Pump	12	0.1 Amps
WL400 TOTAL	670	5.6 Amps